

STANDARD STAIRS

- A standard range to solve the problems of one-off stair-flight production.
- Fast delivery.
- Competitive price.
- High quality appearance – a range of colours is available as well as exposed aggregate and polished stone finishes.
- Supplied with cast-in lifting inserts.
- Full design and detailed drawings supplied with calculations for Building Regulations approval.
- Non-standard spiral stairs or any configuration can be produced in any finish.

DESIGN

Stairs designed generally in accordance with BS 8110: 1985. The standard staircase has been designed to carry an applied load of 4kN/m^2 as specified in BS 6399 Part 1:1984. Maximum flight width 1200mm, minimum flight width 900mm. An applied finish such as plaster, artex or textured paint to the soffit is recommended.

SUPPORT

Can be supported either by steelwork and planks with the use of steel angles, or by a pre-cast landing/boot beam.

FIRE RESISTANCE

1 hour as defined in Table 3.5 BS 8110 Part 1.

Contract List:

British Aerospace, Bristol, Plymouth.
 Royal Devon & Exeter Hospital.
 McCarthy Stone.
 General Accident Insurance.
 Multistorey Car Park, Bolton.
 Yeovil Town Centre Car Park.
 Ebbw Vale Rugby Club.

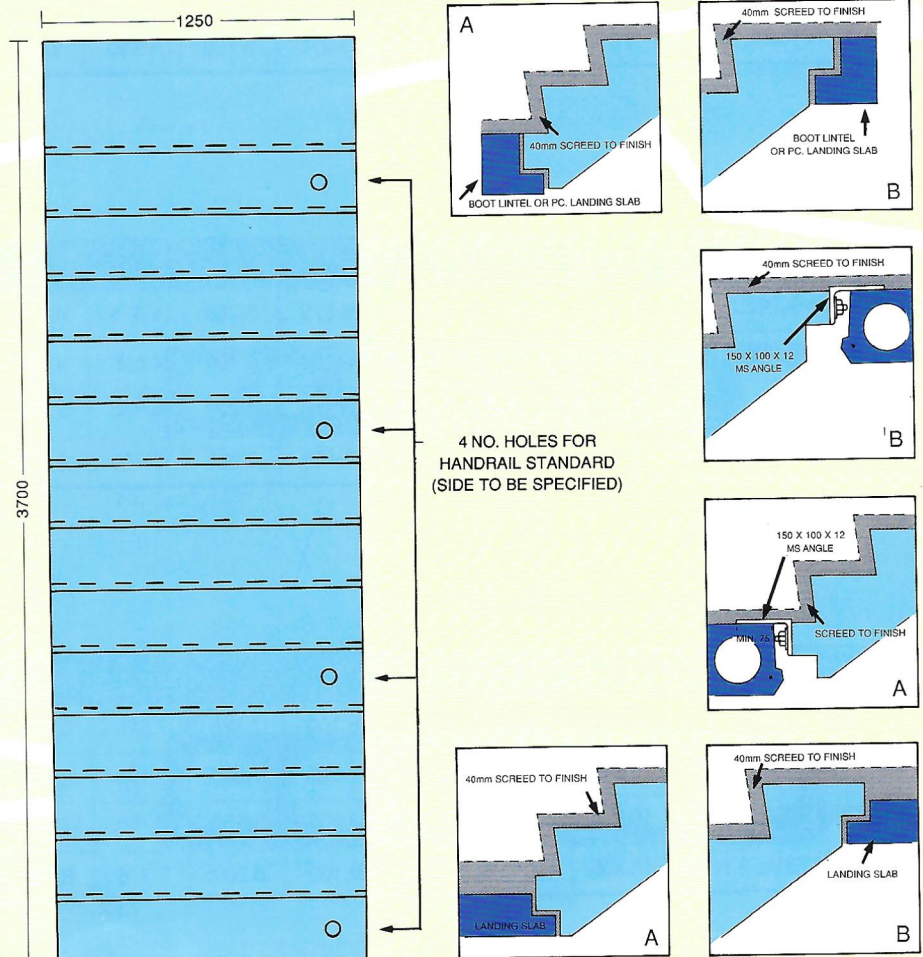
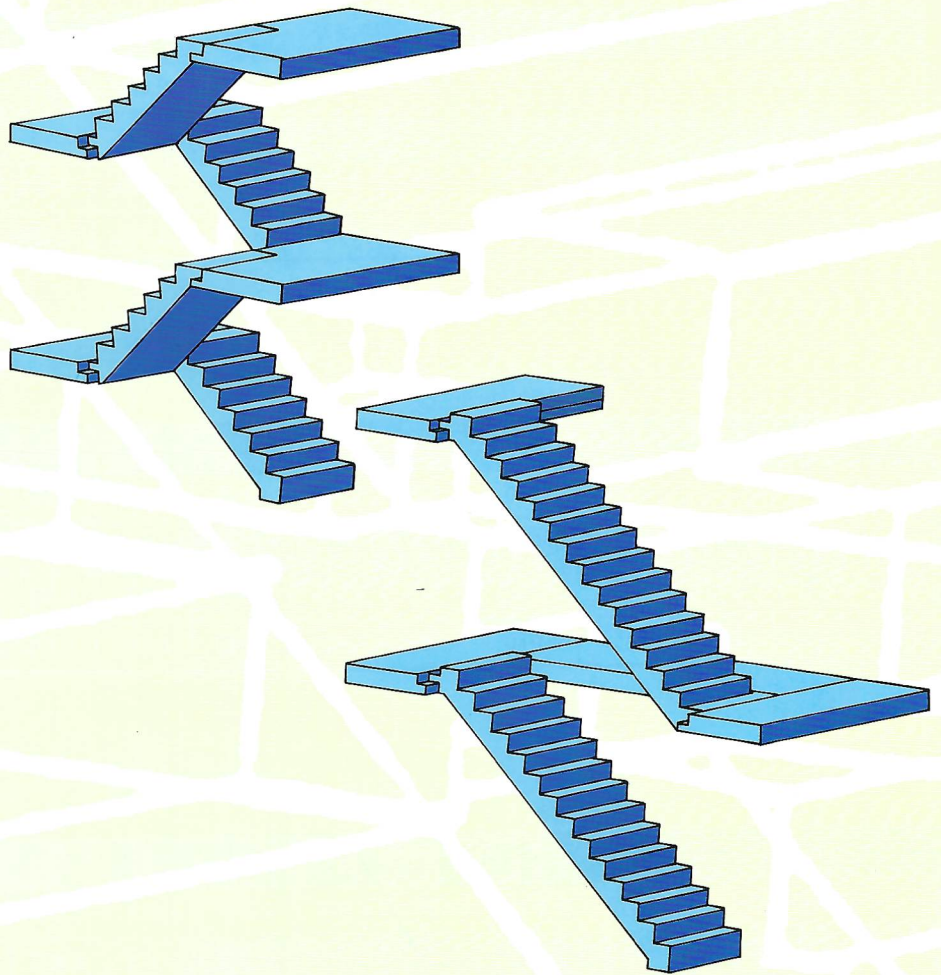

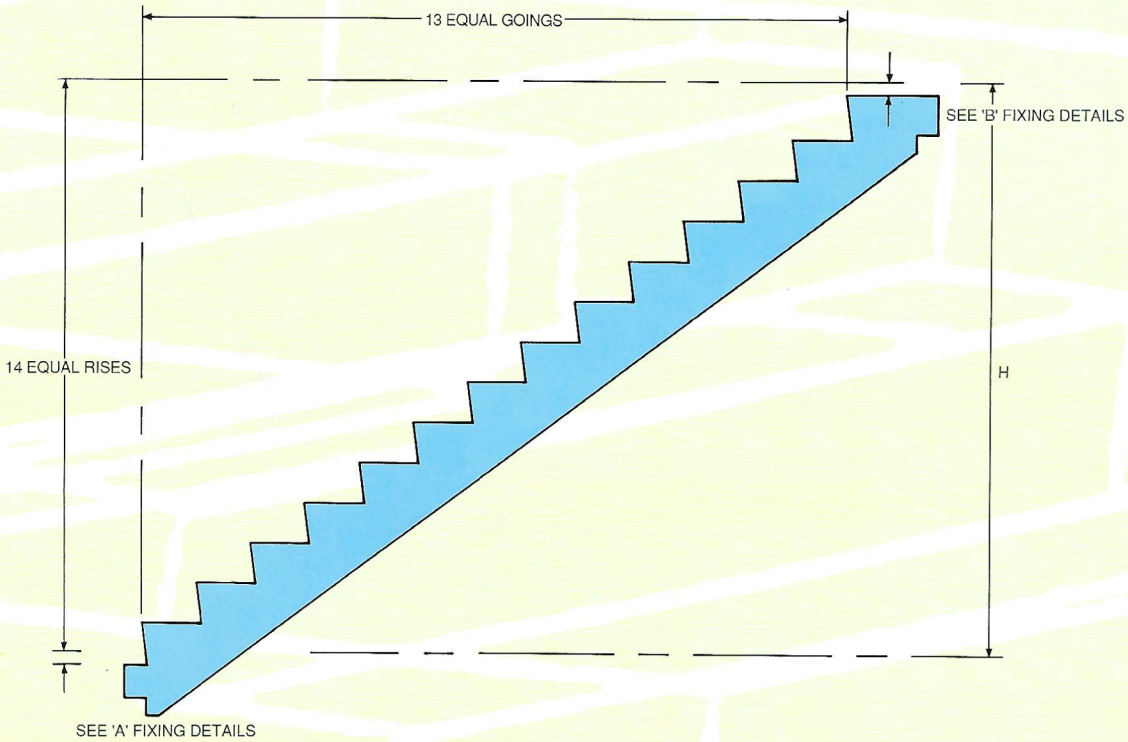
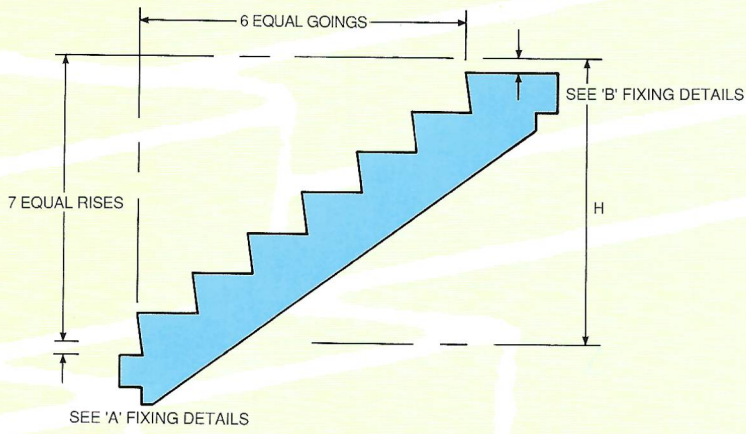

STANDARD 7 RISER UNIT

Max. & Min. Referring to H. Pitch & Risers	(H) Height of Stair Flight	Goings of Stair Flight	Pitch Nom.	Riser mm Nom.	Goings mm Nom.
Min.	1275	1519.5	35.05	182.14	253
Norm.	1300	1500	36.6	185.7	250
Max.	1325	1480.5	38.15	189.2	246.75

STANDARD 14 RISER UNIT

Max. & Min. Referring to H. Pitch & Risers	(H) Height of Stair Flight	Goings of Stair Flight	Pitch Nom.	Riser mm Nom.	Goings mm Nom.
Min.	2550	3289	35.05	182.14	253
Norm.	2600	3250	36.6	185.7	250
Max.	2650	3210	38.15	189.2	247

USEFUL INFORMATION

Staircase Type	Private Giving Single Access	Common Giving Joint or Multi Access	Disabled	Institutional and Assembly Buildings	Any Type not Described
Rise (max.)	220	190	170	180	190
Going (min.)	220	240	250	250	250

The above information has been abstracted from Building Regulations Documents K: 1985, M: 1987 and amendment 1: 1988

Full technical information is available from the Mexboro Sales Department.

Mexboro Standard Structural Concrete products can also be manufactured to your specified dimensions.